



MOUNTING INSTRUCTIONS

**FRONT BUMPER
HONDA RINCON 650/680**

ATventure #166-126M

Ref.	Item Description	Item #	Qty
1	Front Bumper	166-126	1
2	Bolts 2" x 5/16" (Hex)	--	2
3	Flat Washer 5/16"	146-016	2
4	Lock Nut 5/16"	0404-90239	2
5	Round Hexagon Bolt 8mm x 25mm	1014-0855	2
6	Round Plastic Cap 1 1/2"	119-1501618	2

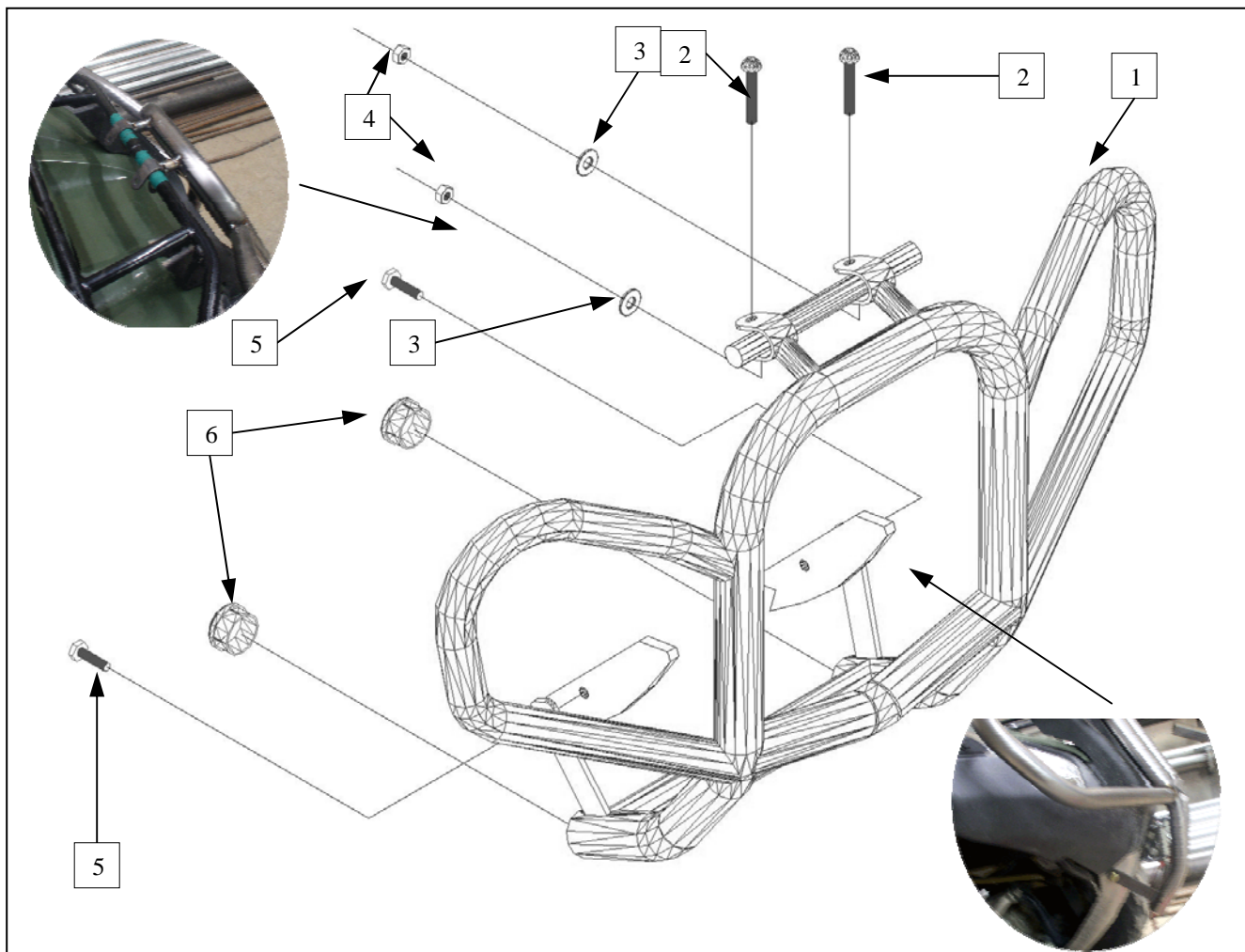

2003-2010

ATventure Components Inc.
 23 Boom Lane, Unit E, Atholville, NB Canada E3N 4E8
 1-866-789-5840 / www.atv-bumpers.com

